

## Wireless Loadshackle

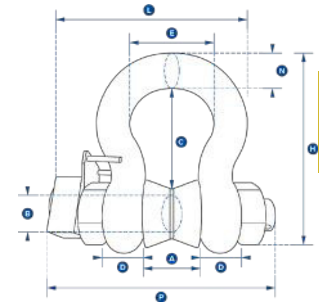

- Capacities of 3.25t to 500t, as well as being obtainable up to 3000t.
- Wireless range of 1000m or 3280ft.
- Every Loadshackle is proof tested.
- Electronics housed in hard anodized enclosure.
- Environmentally sealed to IP67 or NEMA6.
- Battery life of 1200 hrs from 4 x AA batteries.
- Internal antenna.
- Remote on/off from handheld display or software.
- Supplied with a load-centering bobbin.
- 2-year warranty.
- Complies with ASME B30.26.
- Design validated by FEA.
- ATEX Zones 0, 1 & 2 available.
- Bluetooth option is available and is supplied with a free HHP App for iOS and Android.



2



Part Numbers		WLS3.25T	WLS6.5T	WLS12T	WLS25T	WLS55T	WLS85T	WLS120T	WLS200T	WLS300T	WLS400T
Crosby		2789186	2789200	2789183	2789185	2789199	2789201	2789172	2789184	2789188	2789189
Capacity	(te)	3.25	6.5	12	25	55	85	120	200	300	400
	(lb)	7,150	14,300	26,400	55,000	120,000	185,000	260,000	440,000	660,000	880,000
Resolution	(te)	0.005	0.005	0.01	0.02	0.05	0.05	0.1	0.2	0.5	0.5
	(lb)	10	10	20	50	100	100	200	200	1000	1000
Units	(metric)	metric tons									
	(imperial)	pounds									
Weight	(kg)	2.8	3.2	8	18	25	85	125	260	405	662
	(lb)	6.16	7	17.6	40	55	187	276	573	893	1459

Design Factor	5:1 when used with load bobbin										
Battery Type	Loadcell 4 x AA Alkaline										
Battery Life	Loadcell 1200 hours continuous (500 hours if Bluetooth)										
Operating Temp.	-10°C to +50°C / 14°F to 122°F										
Accuracy	±1% full scale										
Frequency	2.4 GHz										
System Range (max)	1000 meters / 3280 feet (100 meters / 328 feet if Bluetooth) (500 meters / 1640 feet if ATEX/IECEX)										
Data Rate	3 updates per second										
Protection	IP67 / NEMA6										
Dimension A	(mm)	26.9	36.6	51.5	73	82.5	127	144	180	205	230
	(in)	1.06	1.44	2.03	2.87	3.25	5.00	5.66	7.09	8.07	9.06
Dimension ØB	(mm)	19.1	25.4	35.1	51	57	83	95	125	150	175
	(in)	0.75	1.00	1.38	2.01	2.24	3.26	3.74	4.92	5.91	6.89
Dimension C	(mm)	56.9	79.7	113	170	189.5	317	364	432.2	505	547.7
	(in)	2.24	3.14	4.45	6.69	7.46	12.48	14.33	17.02	19.88	21.56
Dimension D	(mm)	14.46	20.6	29.5	44.5	51	80	89	110	120	160
	(in)	0.57	0.81	1.16	1.75	2.01	3.14	3.50	4.33	4.72	6.30
Dimension E	(mm)	42.9	58	82.5	127	146	190	238	280	305	325
	(in)	1.69	2.28	3.25	5.00	5.75	7.48	9.37	11.02	12.01	12.80
Dimension H	(mm)	106	148	210	313	348	539	624	769	904	1006.5
	(in)	4.17	5.83	8.27	12.32	13.70	21.22	24.56	30.28	35.59	39.63
Dimension L	(mm)	135	156.5	201	275	306	393	445	529.7	586.7	667.2
	(in)	5.31	6.16	7.91	10.83	12.05	15.47	17.51	20.85	23.10	26.27
Dimension N	(mm)	17.5	24.6	35.1	57	61	85	95	120	140	160
	(in)	0.69	0.97	1.38	2.24	2.40	3.34	3.74	4.72	5.51	6.30
Dimension P	(mm)	150	173	222	290	317	448	488	600	657	765
	(in)	5.91	6.81	8.74	11.42	12.48	17.63	19.21	23.62	25.87	30.12
Crosby Shackle		G2130				G2140		S2135			